

# BarTec®

COMMERCIAL

## COMMERCIAL BLENDERS

Project Name: \_\_\_\_\_  
 Location: \_\_\_\_\_  
 Item #: \_\_\_\_\_ Qty: \_\_\_\_\_  
 Model #: \_\_\_\_\_

# 1 HP BLENDERS



MODEL BTC-329PE



MODEL BTC-329SS



MODEL BTC-329CC (Combo Pack)

### SPECIFICATIONS

All models feature a one (1) HP motor, available 120V/60Hz and 220V/50-60Hz, 6.5 Amps. An On/Off and High/Low Control Panel. Two containers are available, 48 oz Polycarbonate (Model # BTC-329PE) or 32oz Stainless Steel (Model # BTC-329SS), Combo pack (Model # BTC-329CC) features both Polycarbonate and Stainless Steel Containers. Shipping Weight is 8 lbs. Dimensions with Polycarbonate Container are: 15 1/2"H x 6 1/2"D x 6 1/2"L, with Stainless Steel Container: 14 1/2"H x 6 1/2"D x 6 1/2"L.

### FEATURES

- **Unique 1 hp (750 watts) power motor** with 2 speed control provides excellent blending capabilities. Powerful motor benefits users in bars, restaurants, hotels, cocktail bars and juice stores to obtain perfect mixing and high quality drinks.
- **Innovative ingredient Crushing Rib** is designed to eliminate product swirl and pushes the solid product into the rotating blades.
- **Perfect Coupling System** provides easy clutch fitting and noise reduction during operation.

- **Self-Lubricating Ball Bearing System** is built into the blade unit. This system provides a smooth blending operation and maintains motor life.
- **Functional and Efficient Container Shape** and blade are uniquely designed to provide maximum blending capabilities.
- **Unbreakable PC Container** is made of polycarbonate which is durable even in the harshest environments.
- **Stackable 48 Oz Container PC container** utilizes minimal counter space. distinctive measurements marks and ergonomic handle design are perfect for operational convenience.
- **Steady Grip Rubber Feet** enables the blender to firmly attach to countertop. The rubber material absorbs and eliminates operational vibration.
- **International Agency Approvals:** certified by ETL and ETL Sanitation to NSF Standards, CE, GS, ISO 9001.



Specifications subject to change without notice.

Approvals:

# BarTec®

COMMERCIAL

## COMMERCIAL BLENDERS

15712 SW 41st Street • Suite 800 • Ft. Lauderdale, FL 33331

Tel: (954) 202-7419 • Fax: (954) 202-7337

www.asburyfoodservice.com

# BarTec®

COMMERCIAL

## COMMERCIAL BLENDERS

## 1 HP BLENDERS

### PARTS LIST AND FEATURES

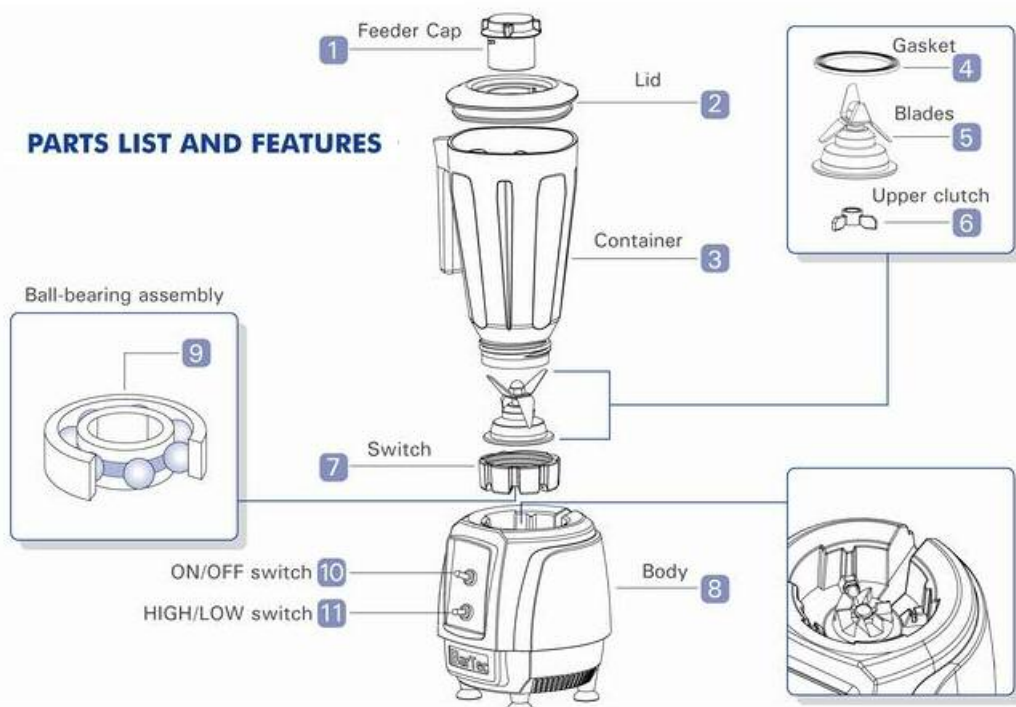

### SPECIFICATIONS

HP	1
WATTS	750
AMPS	6.5
VOLTAGE	120/60
	220/50-60
SPEEDS	2 (high/low)
CONTAINER CAPACITY	
Polycarbonate	48 oz.
Stainless Steel	32 oz.
DIMENSIONS	
With PC	15-1/2"H x 6-1/2"D x 6-1/2"L
With SS	14-1/2"H x 6-1/2"D x 6-1/2"L
SHIPPING WEIGHT	8 LBS.

### FEATURES

- **Unique 1 hp (750 watts) power motor** with 2 speed control provides excellent blending capabilities. Powerful motor benefits users in bars, restaurants, hotels, cocktail bars and juice stores to obtain perfect mixing and high quality drinks.
- **Innovative ingredient Crushing Rib** is designed to eliminate product swirl and pushes the solid product into the rotating blades.
- **Perfect Coupling System** provides easy clutch fitting and noise reduction during operation.
- **Self-Lubricating Ball Bearing System** is built into the blade unit. This system provides a smooth blending operation and maintains motor life.
- **Functional and Efficient Container Shape** and blade are uniquely designed to provide maximum blending capabilities.
- **Unbreakable PC Container** is made of polycarbonate which is durable even in the harshest environments.
- **Stackable 48 Oz Container PC container** utilizes minimal counter space. distinctive measurements marks and ergonomic handle design are perfect for operational convenience.
- **Steady Grip Rubber Feet** enables the blender to firmly attach to countertop. The rubber material absorbs and eliminates operational vibration.
- **International Agency Approvals:** certified by ETL and ETL Sanitation to NSF Standards, CE, GS, ISO 9001.



Specifications subject to change without notice.

Approvals:

# BarTec®

COMMERCIAL

### COMMERCIAL BLENDERS

15712 SW 41st Street • Suite 800 • Ft. Lauderdale, FL 33331

Tel: (954) 202-7419 • Fax: (954) 202-7337

www.asburyfoodservice.com